



Berner- Kochsysteme GmbH & Co. KG

Sudetenstrasse 5 – D-87471 Durach

Tel. +49 (0) 831/697247-0; Fax. - 15

E-Mail: Bernert@induktion.de | www.induktion.de

Operation and instruction manual for built-in pasta cookers



BKEA2/3(E), BKEA1/1(E),
BKEAQ1/1(E), BKEAK1/1(E)
BKEA2/3H(E)

BKE2/3(E), BKE1/1(E),
BKES2/3(E), BKES1/1(E)

It is absolutely **mandatory** to carefully read this operation and instruction manual **BEFORE** mounting – installation – usage of the unit. This will avoid risks of damage to you and the unit.

Summary

Summary	1
Security indications	3
Security regulations	4
Description of danger symbols	4
Risks of the non-observance of the security regulations	4
Safe usage	4
Safety regulations for operators	5
Improper usage	5
Modifications / usage of spare parts.....	5
General.....	5
Application	6
Description of the product	6
Products.....	6
Technical data	6
Operation and control	6
Technical data of the units.....	7
Functional conditions	7
Installation	8
Electrical data of the units (8,0 kW).....	8
BKEA2/3, BKEA2/3H, BKEA2/3E, BKEA2/3HE, BKE2/3, BKE2/3E	8
Electrical data of the units (10,0 kW)	8
BKE1/1, BKE1/1E	8
Electrical data of the units (12,0 kW)	8
BKEA1/1, BKEA1/1E, BKEAQ1/1, BKEAQ1/1E, BKEAK1/1, BKEAK1/1E	8
Electrical data of the units (15,0 kW)	8
BKES1/1, BKES1/1E	8
Installation conditions.....	9
Installation instructions.....	9
Taking the unit into service	9
Installation	9
Operation with 3 power level main switch knob & thermostat	10
Electronic control with potentiometer and digital display with 4 digits (E)	11
Electronic control with digital touch panel (ESRTN)	11
Automatic basket lift.....	12
Functionality test	13
BKEA, BKE	13
BKEA_E, BKE_E	13
Operation	14
Cooking process.....	14
Water tap.....	14
Standard water drain:.....	14
Water drain (WAS) Optional	14

Automatic water tap with water level control (WZN) – optional	15
End of service / intervals.....	15
Decommissioning	15
Error detection	16
Fehlerbehebung	16
Error code messages on the digital display or ESRTN	17
Cleaning	17
Cleaning of the unit	17
Maintenance	18
Guarantee	18
Repair during guarantee period	18
Follow the installation instructions	19
Installation instructions	19
Technical documentation	23
Exploded view BKEA	24
Exploded view BKEA	25
Exploded view BKE	26
Exploded view BKE	27
Exploded view BKE	28
Exploded view BKEA_H	28

Security indications



The present operation and instruction manual must be read carefully and completely. Keep the manual for future use by you or by a future owner. Check the unit after unpacking. If damaged, do not connect to the mains/do not use. Take written note and pictures of the damage and contact technical assistance, otherwise guarantee will be voided. Mounting/installation of the unit must be made according to and following the indications of the present manual. The unit must be used only for cooking of food products through water inside the basin. Surveillance during operation must be guaranteed. Only use in interior, closed environments, unit is not suitable for external use. Do not use with plastic containers or similar accessories as they could overheat and/or melt. The unit is not supposed to be used with an external timer or a remote control.

Danger of fire !

- **NEVER** fill the basin with oil or grease. Hot oil or grease catches fire easily. **Never** leave hot oil/grease unattended. **Never** try to extinguish a fire with water, use a fire blanket, a lid or similar to choke the fire. Turn off the unit and completely extinguish the fire.
- The heating elements of the unit get really hot. **Never** put or store flammable goods (spray cans !) on or near the unit. The unit must be installed or positioned on top of non-flammable work tops only.

Risk of burns !

- The unit and its immediate surroundings can get hot, **never** touch the surroundings of the unit and keep children away. **Never** put any flammable objects in the basin. **Never** store flammable objects nearby or on top of the unit.
- The unit will heat water up to 110° C, pay attention during usage and keep children away.
- If the unit works and heats up, but the display is turned off/the signal lamps are not lit: Disconnect from mains and contact technical assistance.
- Metal objects can get hot in the basin of the unit; **never** put metal objects like knives, forks, spoons or lids inside.
- Turn off the unit through the main switch after every use, in order to save energy and to avoid the risk of burns. Don't wait for the unit to turn off automatically due to missing water.

Electric shock hazard!

- Incorrect repairs are dangerous. Only an authorized customer service technician may carry out repairs or replace damaged power cables. If the unit is out of order, disconnect mains and contact technical assistance.
- Penetrating moisture can cause an electric shock. **Never** use high pressure cleaners or steam cleaners.
- A defective unit can cause an electric shock. **Never** turn "on" a defective unit. Disconnect from mains and contact technical assistance.

Risk of damage !

- The unit is equipped with a security thermostat. Follow the indications for the built-in of the security thermostat.

Attention !

- Do not use rough detergents and abrasive sponges, as they can scratch the unit and its basin.
- **NEVER** take into operation without any water inside the basin. It could lead to damages to the unit.
- Do not use hard or pointed objects on the surface, as it may get damaged, especially on nickel-chromed surfaces.
Aluminium or plastic containers could melt if put in the basin of the unit. **Never** use the surface as a work top.

Security regulations

Description of danger symbols

General danger symbol

Non observance means danger (risk of injuries)



This symbol means **dangerous voltage**.
(Symbol 5036 of IEC 60417-1)



The danger symbols that are applied directly to the unit must be carefully respected and their readability must be ensured at all times.

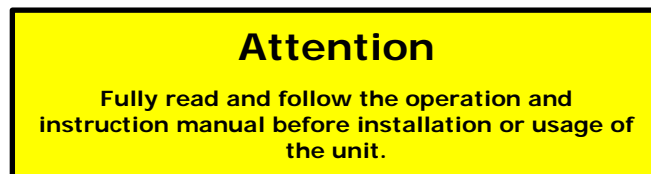

Risks of the non-observance of the security regulations

Danger for people, ambient and the unit itself are caused if the security regulations are not observed. If the security regulations are not observed, eventual claims for damages will be rejected.

Details of the risks of the non-observance

(Examples):

- Danger to people due to electrical causes
- Danger to people due to overheated parts
- Danger to people through an overheated basin
- Danger to people due to hot water

Safe usage

The security regulations of the present manual, the local and national electrical regulations as well as the work security regulations and the internal work, usage and security regulations from the employer must be thoroughly respected and followed at all times.

- Pay attention to hot food and liquids during the cooking process.
- **ATTENTION:** Take care of the potentially slippery floor around the unit, caused by the cooking processes. There is a serious risk of slipping and falling.
- **Never** use the surface as a work top, not even temporarily!

Safety regulations for operators

- **Attention!** Never fill cold water /ice into the hot unit. Ignoring this advice could lead to damages of the unit. **Consequences of ignoring:** The basin could deform, tearing of the joint material due to extreme temperature fluctuations and therefore destruction of the seal, that could lead to penetration of liquids or grease and damage the unit itself.
- If the seal is broken, turn OFF the unit and disconnect from mains. Please do not touch any part inside the unit.
- The unit gets hot when the heating element is working. To avoid risk of burns, never touch the water inside of the basin.

Please pay attention for hot food and liquids during the cooking process

- **ATTENTION:** Take care of the potentially slippery floor around the unit, caused by the cooking processes. There is a serious risk of slipping and falling.
- In order to avoid overheating of the basin due to boiling dry, **never** use the unit without supervision and **never** turn ON the unit without any water.
- Turn OFF the unit through the main switch after every use, in order to save energy and to avoid the risk of burns. It also avoids the unit to be turned on inadvertently.
- **Never** use the surface as a work top, not even temporarily!
- Please only use proper and recommended containers and baskets.
- Absolutely avoid the penetration of liquids into the unit and the overflow of food and water over the edge. Don't clean the unit with a pressure cleaner or water tap.

Improper usage

The correct functioning of the unit can be guaranteed only through proper usage. The indicated maximum levels of the technical data must not be exceeded or fall below under no circumstances. Improper usage could void the OEM guarantee.

Modifications / usage of spare parts

Please contact the OEM-manufacturer if you intend to modify the unit. To ensure security of the unit, please use only original spare parts and accessories from the OEM-manufacturer. **During repairs and test runs, please make sure the unit is properly standing on a secure surface.**

Attention! Before cleaning or repairing the unit, it must be completely disconnected from mains (pull the plug).

General

This operation and instruction manual contains important information regarding mounting, installation and usage of the unit that need to be respected. It must be read carefully and completely **before** installation and usage by the installer and also all operation personnel. Keep this manual at hand for future consultations!

Application

The unit has been conceived for the boiling or keeping warm of food products inside the basin filled with water. Any other use is considered improper and could void the OEM guarantee.

Description of the product

Products

BKEA2/3(E), BKEA1/1(E), BKEAQ1/1(E), BKEAK1/1(E)

- Fast heating of the water
- Operation through thermostat and power level regulation
- Easy operation through knob control or electronic touch control panel
- Optional electronic temperature control (ESRTN)

BKEA2/3H(E)

- Fast heating of the water
- Operation through thermostat and power level regulation
- Easy operation through knob control or electronic touch control panel
- Optional electronic temperature control (ESRTN)
- Control of automatic basket lift for each basket

BKE2/3(E), BKE1/1(E), BKES2/3(E), BKES1/1(E)

- Fast heating of the water
- Operation through thermostat and power level regulation
- Easy operation through knob control or electronic touch control panel
- Optional electronic temperature control (ESRTN)
- Easy cleaning by pivoting heating

Technical data

Operation and control

BKEA2/3, BKEA1/1, BKEAQ1/1, BKEAK1/1, BKEA2/3H

Signal lamp	„Operation“	green	„ON“ if unit functioning
Signal lamp	„Heating up“	yellow	„ON“ if heating element functioning
Signal lamp	„Stb trigger off“	red	„ON“ by triggered Stb
Button	„Valve open “	blue	(Open water tap)
Button	„Valve open “	yellow	(Open water drain) *

BKEA2/3E, BKEA1/1E, BKEAQ1/1E, BKEAK1/1E, BKEA2/3HE

Potentiometer	0 Ohm – 10kOhm		electronic regulator
Display	4-digits	red	2,8V DC/ca. 60mA
Signal lamp	„Operation“	green	„ON“ if unit functioning
Button	„Valve open “	blue	(Open water tap) *
Button	„Valve open “	yellow	(Open water tap) *

BKE2/3, BKE1/1, BKES2/3, BKES1/1

Signal lamp	„Operation“	green	„ON“ if unit functioning
Signal lamp	„Heating up“	yellow	„ON“ if heating element functioning
Signal lamp	„Pivoting heating“	red	„ON“ by pivoting heating
Button	„Valve open “	blue	(Open water tap)
Button	„Valve open “	yellow	(Open water drain) *

BKE2/3E, BKE1/1E, BKES2/3E, BKES1/1E

Potentiometer	0 Ohm – 10kOhm		electronic regulator
Display	4-digits	red	2,8V DC/ca. 60mA
Signal lamp	„Operation“	green	„ON“ if unit functioning
Signal lamp	„Pivoting heating“	red	„ON“ by pivoting heating
Button	„Valve open “	blue	(Open water tap)*
Button	„Valve open “	yellow	(Open water tap)*

Technical data of the units

Dimensions	Ext. dim. B x T	Int. dim.	Capacity
BKEA2/3(E)	400 x 600 mm	GN2/3-220	18 Liter
BKEA2/3H(E)	400 x 600 mm	GN2/3-220	18 Liter
BKEA1/1(E)	400 x 720 mm	GN1/1-220	28 Liter
BKEAQ1/1(E)	660 x 550 mm	GN1/1-220	28 Liter
BKEAK1/1(E)	550 x 520 mm	GN1/1-220	28 Liter

Models	Voltage	Switch	Nom. power	Weight
BKEA2/3	400V/3~/N/PE	3-Stufen 0-I-II-III	2,4/4,8/8,0 kW	20 kg
BKEA2/3H	400V/3~/N/PE	3-Stufen 0-I-II-III	2,4/4,8/8,0 kW	20 kg
BKEA1/1	400V/3~/N/PE	3-Stufen 0-I-II-III	4,0/8,0/12,0 kW	25 kg
BKEAQ1/1	400V/3~/N/PE	3-Stufen 0-I-II-III	4,0/8,0/12,0 kW	25 kg
BKEAK1/1	400V/3~/N/PE	3-Stufen 0-I-II-III	4,0/8,0/12,0 kW	25 kg
BKEA2/3E	400V/3~/N/PE	Elektronik	0 - 8,0 kW	20 kg
BKEA2/3HE	400V/3~/N/PE	Elektronik	0 - 8,0 kW	20 kg
BKEA1/1E	400V/3~/N/PE	Elektronik	0 - 12,0 kW	25 kg
BKEAQ1/1E	400V/3~/N/PE	Elektronik	0 - 12,0 kW	25 kg
BKEAK1/1E	400V/3~/N/PE	Elektronik	0 - 12,0 kW	25 kg

Dimensions	Ext. dim. B x T	Int. dim.	Capacity
BKE2/3(E)	400 x 600 mm	GN2/3-220	18 Liter
BKES2/3(E)	400 x 600 mm	GN2/3-220	18 Liter
BKE1/1(E)	400 x 720 mm	GN1/1-220	28 Liter
BKES1/1(E)	400 x 720 mm	GN1/1-220	28 Liter

Models	Voltage	Switch	Nom. power	Weight
BKE2/3	400V/3~/N/PE	3-Stufen 0-I-II-III	2,4/4,8/8,0 kW	20 kg
BKE1/1	400V/3~/N/PE	3-Stufen 0-I-II-III	3,3/6,6/10,0 kW	25 kg
BKES2/3	400V/3~/N/PE	3-Stufen 0-I-II-III	4,0/8,0/12,0 kW	20 kg
BKES1/1	400V/3~/N/PE	3-Stufen 0-I-II-III	5,0/10,0/15,0 kW	25 kg
BKE2/3E	400V/3~/N/PE	Elektronik	8,0 kW	20 kg
BKE1/1E	400V/3~/N/PE	Elektronik	10,0 kW	25 kg
BKES2/3E	400V/3~/N/PE	Elektronik	12,0 kW	20 kg
BKES1/1E	400V/3~/N/PE	Elektronik	15,0 kW	25 kg

Functional conditions

- o max. tolerance of the mains voltage/nominal voltage +5%/-10%
- o Frequency 50 / 60 Hz
- o Protection class IP 11

Installation

Electrical data of the units (8,0 kW)

BKEA2/3, BKEA2/3H, BKEA2/3E, BKEA2/3HE, BKE2/3, BKE2/3E

3-phases (Voltage 400V/3~/N/PE +5% / -10%)

Anschluss	Colour	Frequency	Control fuse
Control voltage	Brown, Black	50 / 60 Hz	F6,3A
Phase	Brown, Black, Grey or 1, 2, 3		-
N	Blue or 4		-
PE	Yellow/Green		

Electrical data of the units (10,0 kW)

BKE1/1, BKE1/1E

3-phases (Voltage 400V/3~/N/PE +5% / -10%)

Anschluss	Colour	Frequency	Control fuse
Control voltage	Brown, Black	50 / 60 Hz	F6,3A
Phase	Brown, Black, Grey or 1, 2, 3		-
N	Blue or 4		-
PE	Yellow/Green		

Electrical data of the units (12,0 kW)

BKEA1/1, BKEA1/1E, BKEAQ1/1, BKEAQ1/1E, BKEAK1/1, BKEAK1/1E

3-phases (Voltage 400V/3~/N/PE +5% / -10%)

Anschluss	Colour	Frequency	Control fuse
Control voltage	Brown, Black	50 / 60 Hz	F6,3A
Phase	Brown, Black, Grey or 1, 2, 3		-
N	Blue or 4		-
PE	Yellow/Green		

Electrical data of the units (15,0 kW)

BKES1/1, BKES1/1E

3-phases (Voltage 400V/3~/N/PE +5% / -10%)

Anschluss	Colour	Frequency	Control fuse
Control voltage	Brown, Black	50 / 60 Hz	F6,3A
Phase	Brown, Black, Grey or 1, 2, 3		-
N	Blue or 4		-
PE	Yellow/Green		

Installation environment

- max. environmental temperature

storage >-0°C to +70°C in function >+5°C to +35°C

- max. relative humidity

storage > 10% to 90% in function > 30% to 90%

Installation conditions

The unit must be placed and installed in a plain and even surface. The installation surface must be suitable to carry a weight of at least 50 kgs. The disconnection device from mains must be easily accessible.

The security thermostat must be installed easily accessible in the lower compartment



Installation instructions

The following Points must always be observed during installation:

- Make sure that the main voltage corresponds to the voltage indicated on the nameplate of the equipment.
- All electric installations must fulfil the local building code regulations. All regulations issued by the national electricity authorities must be observed.
- The unit is equipped with a main cable and a plug which can be plugged into a socket.
- When using fault-current circuit breakers, they must be designed for a minimum fault current of 30 mA.
- The operators must ensure that all installation, maintenance and inspection tasks are done by authorized and trained personnel only.

**For the electric connection of the unit pay attention.
The laws and regulations of the country have to be adhered!**

Attention
Wrong voltage could
damage the unit

Attention
The electrical connections must be
done by authorized and trained
personnel only.

Taking the unit into service

Installation

The unit is equipped with a power cable. It can be connected to a socket through a plug. Electric installations must be carried out by registered installation companies only, observing the specific national and local regulations. These companies are responsible for correctly interpreting all regulations and performing the installation in compliance with the safety instructions. Indications on warning signs and nameplates must be strictly observed. Check and ensure that the main voltage corresponds to the voltage indicated on the nameplate of the unit.

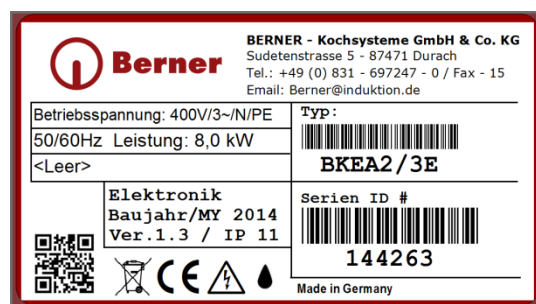
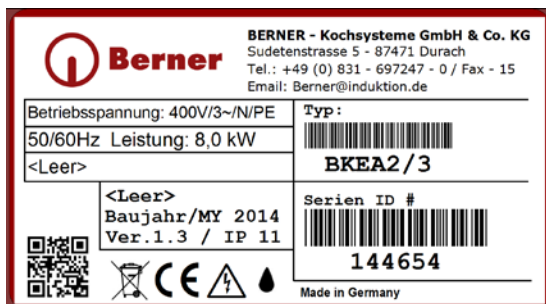

If the unit is installed in the immediate surroundings of a wall, a partition wall, kitchen cabinets, decorative panels, etc., we recommend these to be of non-combustible material; otherwise they must be covered with suitable non-combustible and heat-insulating material and the fire safety regulations must be observed with utmost care!

Please turn the main switch in "OFF" (0) position, before connecting the unit to the mains. The conditions indicated in chapter 3.2 "Installation conditions" must be met.

Operation with 3 power level main switch knob & thermostat

3 power level main switch knob

Position OFF:

0 towards the mark (●)



Position ON:

I, II, III towards the mark (●)

Power level towards the mark (●)

Selected power level III, II, I



I Keeping warm	II Reduced power	III Maximum power
-------------------	---------------------	----------------------

Temperature selection through knob

The position between 50 and 110 marks the selected position of the thermostat knob.

Attention!

The maximum temperature can be reached only on power levels II or III.

Position heating OFF:

0 towards the mark (●)

Position heating ON:

Any position, whose direction points to the mark (●). (50°C) bis (110°C)

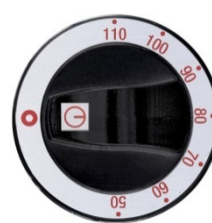

Electronic control with potentiometer and digital display with 4 digits (E)

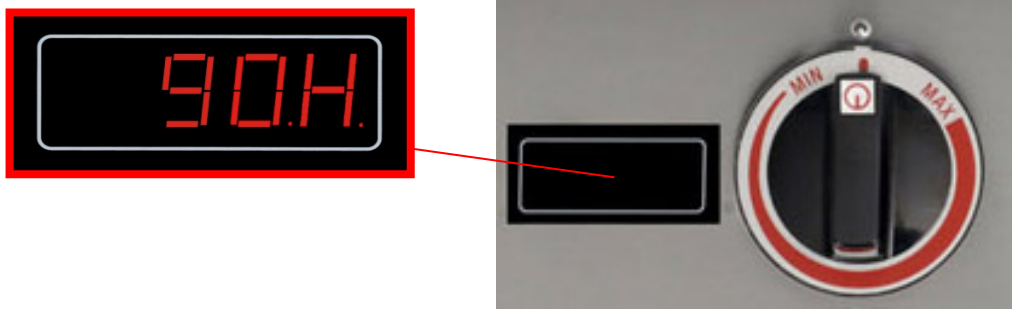

The temperature can be selected, using the knob, between 35 up to 110°C.
The display will show as follows:

70. □.	Selected temp. 70°C, actuality temp. is too low, symbol □ appears, Heating ON: dot on the right of the symbol
25. □.	Actually temp. 25°C, all 10 sec., actuality temp. is too low, symbol □ appears, Heating ON: dot on the right of the symbol
70. H.	Selected temp. 70°C, actuality temp. is +/- 2°C, H appears, Heating OFF
105. ▣	Actually temp. 105°C, actuality temp. too high, symbol ▣ appears. Heating OFF

Electronic control with digital touch panel (ESRTN)

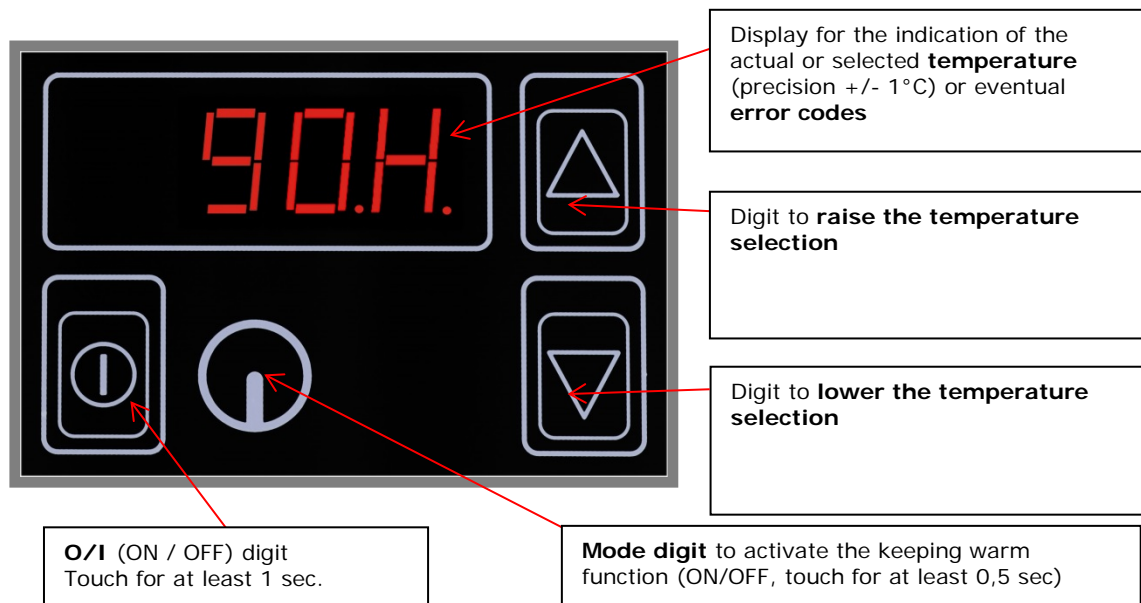

A led will light up whenever you touch a digit, to confirm the selection has been made.

Automatic basket lift

Manual for noodle/fryer timer engine control:

The operation takes place separately for each hoist motor via a touch control panel with the buttons on/off, Berner logo button, buttons up/down. After switching on the power, the time is 10 minutes. The time can be adjusted with the up/down buttons. The on/off button starts the process and the respective motor drive up the baskets. Only when the basket has arrived in the end position, the time is started. During the time, you can stop manually with the button  and start up the basket. After a good period of time, the basket start up high and the time set before the timer starts is displayed again. Now another process can be started, or first the time can be changed and then started.

Touch-panel for automatic basket lift

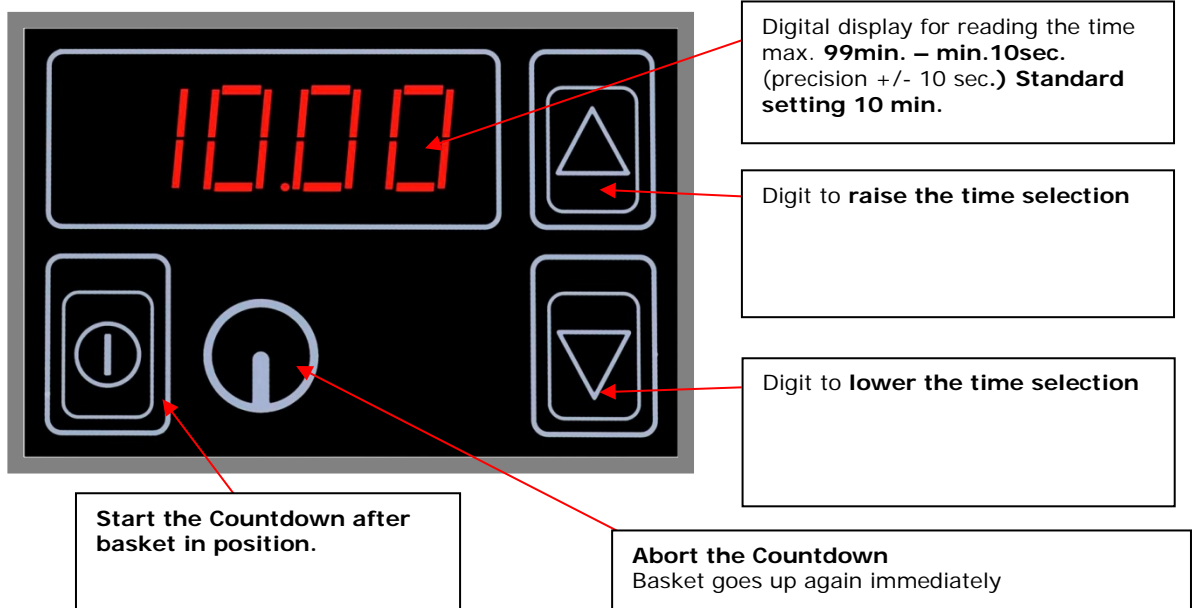

After the program has run normally, the basket moves to the upper position and sets the timer to the preset time back to readiness for the next cooking process.

Functionality test

BKEA, BKE

The functionality test must be made once the operator knows how to use the unit.

Remove all objects from the basin. Please stop the functionality test should a problem or a defect occur. Turn OFF the unit and disconnect it.

The unit must NEVER, UNDER NO CIRCUMSTANCES be turned ON without any water inside the basin!

Once the main switch (power level switch) is turned into ON position the green signal lamp will light up. With the thermostat knob also in ON position, the heating element will start to heat up the water contained in the basin. The temperature selection is between 35/50 and 110°C (**maximum temperature can be reached only with power level switch on II or III**). Once the selected temperature is reached, the heating will stop.

BKE(S)2/3(E), BKE(S)1/1(E): The device works only with non-tilted heating.

Attention

The heating element or the bottom of the basin gets very hot. In order to avoid risks of burns, NEVER touch it.

- Put the basket on the punched bottom plate or into the relative hook of the automatic basket lift system (optional; if available).
- Select the desired temperature through the thermostat knob (between 35/50° und 110°C). The signal for the heating element (yellow) will light up and the water gets heated.
- Turn the main switch to OFF position. The signal lamps will turn OFF and the heating will stop.

If the signal lamp or the touch control panel doesn't light up, please check the following:

- The unit is correctly connected to the mains?
- The main switch is in ON position?
- At BKE(S)2/3(E), BKE(S)1/1(E): Heating panned?

BKEA_E, BKE_E

- When switching on, the software version is briefly displayed „U3.xx“
- Select the desired temperature with the regulator and 4-digit display ON (a position between 20° and 110°C). The operating indicator (yellow) lights up, the water is heated up.
- (E) Turn the knob to the 0 position. The heating process stops and the power indicator and the digital indicator go out.
- (ESRTN) Switch off the device via the sensor keypad. The heating process is stopped, the operating display goes out, the digital display continues to display the current temperature (<20°C). If the temperature is > 20°C, the digital display goes out as well.

Operation

Cooking process

Please fill the basin with sufficient amount of water (the basin must be filled at least with 100 mm of water in height). Never let this amount fall below when using the unit. If this occurs, an optical error code will appear. The error code can **ONLY** be reset through disconnection of the mains. Select the desired power level on the main switch and the desired temperature on the thermostat knob. After reaching the temperature (the yellow signal lamp will turn OFF), the unit is ready to use. The green signal lamp means unit ON. Whenever the yellow signal lamp lights up, the heating element is in function (risk of burns!)

Green signal lamp	Unit in function „ON“
Yellow signal lamp	Heating element in function „ON“
Red signal lamp	BKEA: error code „overheating- Security thermostat triggered“
Red signal lamp	BKE: Warning „Heating panned“

BKEA / BKEA_E / BKEA2/3H / BKEA2/3HE / BKE / BKE_E		
Position min.	> minimal temperature	ca. 35° / ca. 50° Celsius
Position max.	> maximal temperature	ca. 110° Celsius

Water tap



**Attention! The water hardness degree must be between 5-7.
Attention! The water pressure must be below 1 Bar!**

To replenish the basin push the blue button with the water tap design (see image). Water flows until the button gets pushed again.

The water drain tap (standard) is made through a three-way ball valve under the basin.

Standard water drain:

Turn OFF the unit before draining the water from the basin. Please put a suitable container under the ball valve or else connect the drain tube with a fixed drain connection. Carefully open the ball valve to drain the warm water into the container. To replenish the basin again, push the blue button with the water tap design (see image). Water flows until the button gets pushed again.

Water drain (WAS) Optional

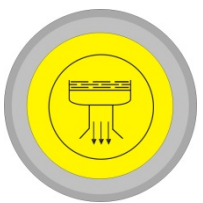

A fixed connection is necessary. Turn OFF the unit before draining the water from the basin. Pushing the yellow button (see image), the ball valve will open automatically. As soon as the basin is empty and to close the ball valve, push the button again. To replenish the basin again, push the blue button with the water tap design (see image). Water flows until the button gets pushed again.

This function also works with the unit turned OFF.



Risk of burns through hot water draining from the basin!

Automatic water tap with water level control (WZN) – optional

The basin replenishes automatically. The basin will be filled up to the operational level. This level will be automatically controlled through a water level electrode. Please ensure cleanliness of the electrode at all times. If the water level falls below the operational level, the tap will replenish automatically up to the previous level.

→ **This function doesn't avoid replacement of water.**

→ **Please replace the water regularly!**

Dry run protection

If the pasta cooker is switched on and there is no water in the basin, it heats up to over 180°C (heating) and is then switched off immediately by the over temperature switch. Only from below 90°C, the heater turns on again. Caution is advised and it is forbidden to accelerate the cooling process abruptly. Filling with cold water can cause stress cracks in the cooker. If the electronics fail when switching off (technical defect), a mechanical safety temperature limiter (STB) is additionally installed on the heater, which switches off at 237°C at the latest. Only after the pool has cooled can it be reset again by pressing in the unlocking button. The number of "emergency shutdowns" and thus the lifetime of the STB is limited.

After filling with fresh water, the pasta cooker can be switched on again.

End of service / intervals

At the end of the service or during service intervals, turn the thermostat in OFF position.

Decommissioning

If the unit will not be used for a longer period, please pull the plug from the socket. Make sure that no liquids can penetrate into the unit and never clean it with a pressure cleaner.

Error detection

Attention

Do not open the unit!
Dangerous voltage!

The unit must only be opened by trained and authorised personnel. Please stop any usage if malfunctions occur or liquids are penetrated into the unit. Turn it OFF immediately and pull the plug from the socket. Never touch any part inside the





unit. The error detection and further actions than the ones described below must be made only through authorised and trained personnel.

Fehlerbehebung

Defect	Possible cause	Actions by operator
Unit doesn't heat up. Signal lamp doesn't light up	No mains power	Is the unit connected to the mains power: Power cable connected correctly? Main switch ON?
Unit doesn't heat up.	The security thermostat intervened	If the security thermostat intervened, the <u>cause must be first established and the problem resolved before resetting the same</u> . <i>Once the unit is cooled down, carefully push the red button in order to reset the unit. If the button is pushed while the unit is still too hot, the security thermostat could get damaged.</i>
	The security thermostat intervened	The security thermostat could also intervene if the ambient temperature is below 0°C. To reset it, the security thermostat must be heated up at least 20°C first.
	Main switch and/or thermostat in OFF position	Check and turn in ON position
	Unit out of order	Disconnect the unit from mains and get in contact with technical assistance..
	Boil dry security intervened	Resolve the problem and reset the unit <u>disconnecting the mains</u> .
Insufficient heating. Signal lamp lights up	Heating element out of order	Disconnect the unit from mains and get in contact with technical assistance.
	Power level too low	Check and select higher power level
	One phase is missing	Check the fuses on the mains connection
	Red signal lamp blinks	Water level too low or too much starch residues in the basin. <u>Replenish/replace water</u> .
	Unit out of order	Disconnect the unit from mains and get in contact with technical assistance.
No reaction when turning the knob	Thermostat out of order	
Heating works in intervals / turns ON-OFF regularly		

In the case of repairs only OEM spare parts according to the relative spare part list are to be used. This also applies to mechanical parts or exterior metallic parts when they are to be replaced.

Error code messages on the digital display or ESRTN

Anzeige	Bedeutung	Erklärung
	Fault 1	Missing potentiometer or out of order, value >1075
	Fault 2	Temperature cut-off or probe interrupted > 260°C
	Fault 3	Short-circuit on the temperature probe or temperature too low < -15°C (displayed every 5 sec. In OFF position)
	Residual heat indicator	Potentiometer in OFF position, residual heat > 45°C

Cleaning

Attention! Before cleaning or repairing the unit, it must be completely disconnected from mains (pull the plug). A regular cleaning together with care and maintenance of the unit are part of the proper usage of the unit.

List of actions according to the type of dirt:

Dirt type	Detergent
Slight dirt	Soft and wet towel (scottex ®) with soapy water or industrial kitchen detergent
Consistent dirt	Stainless steel sponge with wooden spatula, with soapy water or industrial kitchen detergent
Lime and water stains	Stainless steel cleaning cream or water with vinegar
Encrusted, caked dirt	Let sit with hot water and vinegar overnight, then use stainless steel sponge with wooden spatula. Eventually repeat. A ceran glass scraper could also be used for removing caked dirt

If you use specific detergents, please make sure to remove all residues through a soft and wet cloth or tissue (scottex ®). We recommend not using abrasive detergents, as they can corrode and/or scratch the surface of the basin.

Never use a steel brush to clean the basin. If ignored, the OEM-guarantee will be voided.

**Absolutely avoid penetration of any liquid in the unit !
Never clean with a high pressure cleaner!**

Cleaning of the unit

- Remove the baskets from the basin and wash in dishwasher
- Remove punched bottom plate and dripping plate and wash in dishwasher
- Clean the unit according to the above list, rinse thoroughly with clean water.
- Dry the unit and pay attention not to leave dirt or dirty water in the drain opening.
- Relay the punched bottom plate, baskets and dripping plate.

Maintenance

The user must ensure that all components that are relevant for security are functional at all times.

Attention

Do not open the unit!
Dangerous voltage!

The unit must be opened only by authorised and trained personnel.

Attention! Before cleaning or repairing the unit, it must be completely disconnected from mains (pull the plug).

At the end of the product life cycle, the unit must be disposed of correctly.

Avoid misuse:

The unit must not be used by untrained operators. Units ready to be disposed of shall not be taken into function again. The unit is composed of commercial electric, electromechanical and electronic parts. No batteries are installed/used within the unit. The responsibility for the correct and secure disposal is on the user solely.

Note for disposal

Units to be disposed of can be sent back to the OEM-manufacturer for disposal from our side. Only sufficiently stamped parcels are accepted.



Delivery address:

Berner- Kochsysteme GmbH & Co. KG

Sudetenstrasse 5 – D - 87471 Durach

Tel. +49 (0) 831/697247-0; Fax. - 15

E-Mail: Berners@induktion.de | www.induktion.de

Guarantee

With the present unit you acquired a high quality appliance made by BERNER. The OEM-guarantee on the unit is 12 (twelve) months from date of purchase.

Repair during guarantee period

Please get in contact with your technical assistance or wholesaler.

**Please observe the following points when installing this BERNER unit:
Follow the installation instructions**

A partition sheet must be installed under the unit in order to fix the security thermostat supplied together with the unit, easily accessible. This partition sheet must be removable as technical assistance may require accessing the unit. If this is not feasible, other solutions must be checked. We are at your disposal for a support.

The face plate/control panel is not included, but available as an optional.

In order to assure perfect functioning, carefully observe the present instruction manual.

We suggest to prepare the opening with a small overhang of 10-12 mm height around the opening itself, in order to avoid any penetration of liquids. Apply a continuous gasket of heat resistant silicone (i.e. Pactan 6076, available through BERNER) and also close the outside gap between unit and worktop with the same silicone.

Penetration of liquids could damage the unit.

Installation instructions

Please observe the following points:

- **Make sure that the main voltage corresponds to the voltage indicated on the nameplate of the equipment.**
- All electric installations must fulfil the local building code regulations. All regulations issued by the national electricity authorities must be observed.
- The unit is equipped with a main cable and a plug which can be plugged into a socket.
- When using fault-current circuit breakers, they must be designed for a minimum fault current of 30 mA.
- The operators must ensure that all installation, maintenance and inspection tasks are done by authorized and trained personnel only.

Specific point for digital touch control

- The cables for the display must be installed separately from other cables.

Built-in instructions for smooth surface

(Ver. A) of the digital touch control

Electronic control mounted on frame with ceramic glass

Please follow the built-in instructions

Following the instructions the reliable functioning and a long product life cycle are guaranteed. Ignoring them you may void the guarantee.

Check the built-in versions on [page 210 of the 2013 price list](#).

example: mounting on face plat/control panel

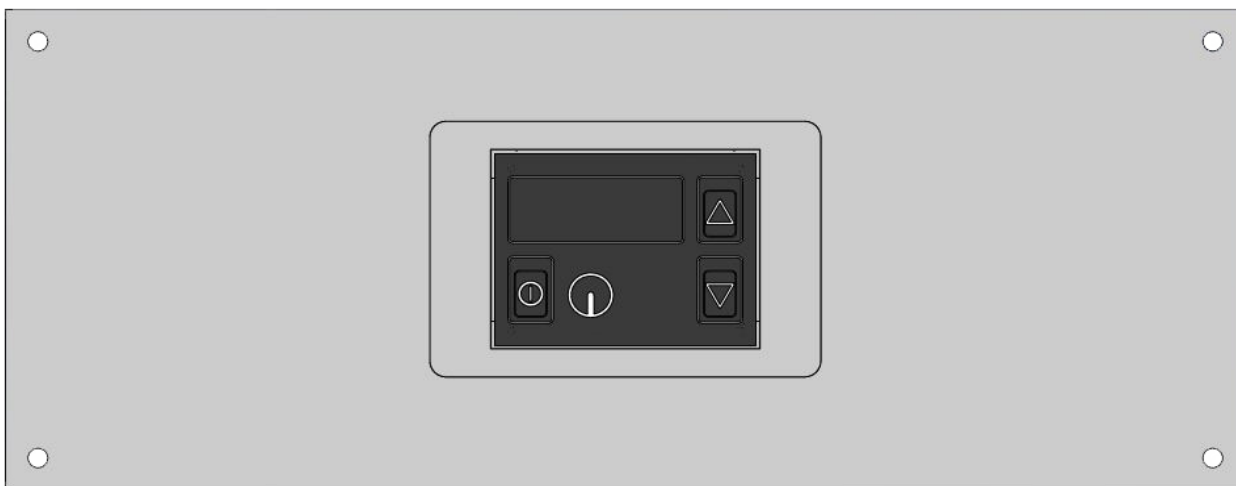

exploded view: version A

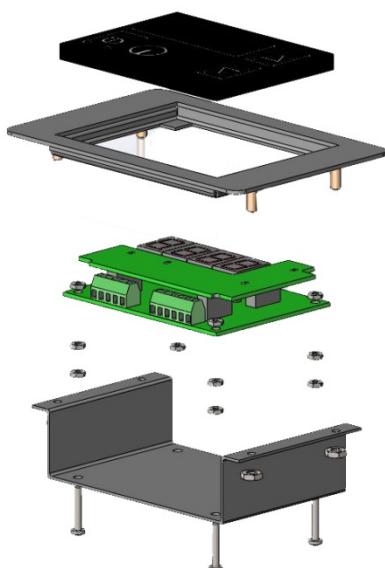

mounted version



Built-in instructions for smooth surface

(Ver. A2) of the digital touch control

Electronic control mounted on frame with ceramic glass

Please follow the built-in instructions

Following the instructions the reliable functioning and a long product life cycle are guaranteed. Ignoring them you may void the guarantee.

Check the built-in versions on [page 210 of the 2013 price list](#).

example: mounting on face plate/control panel

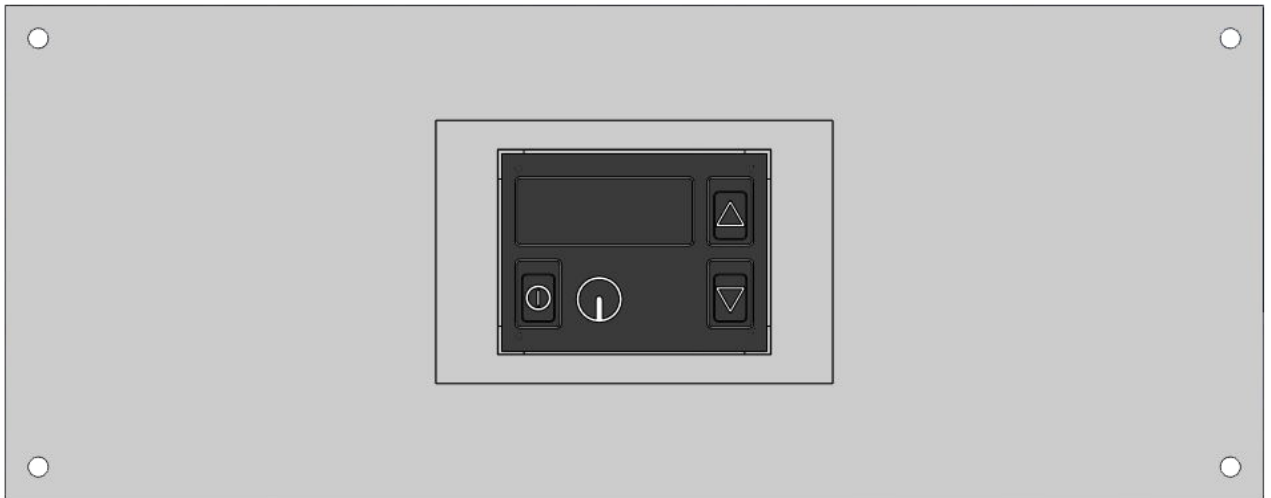

exploded view: version A2

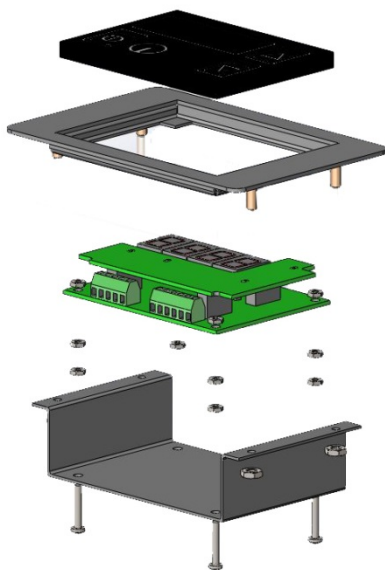

mounted version

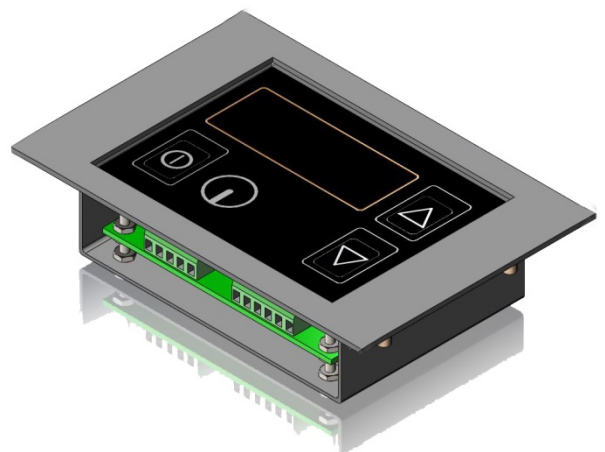

Built-in instructions for smooth surface

(Ver. B) of the digital touch control

Electronic control mounted on frame with ceramic glass

Please follow the built-in instructions

Following the instructions the reliable functioning and a long product life cycle are guaranteed. Ignoring them you may void the guarantee.

Check the built-in versions on [page 210 of the 2013 price list](#).

example: mounting on face plate/front panel

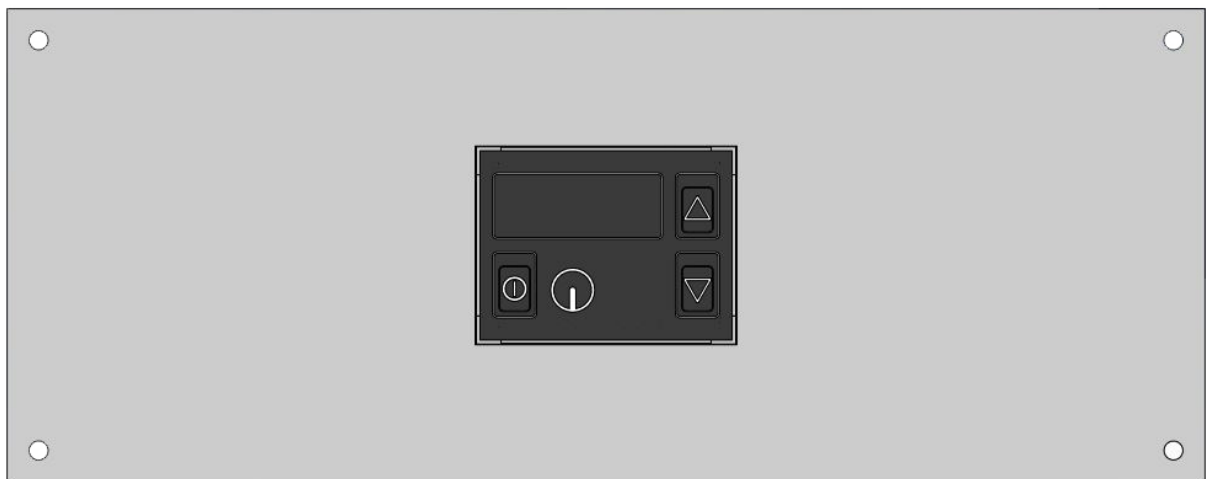

exploded view version B

mounted version

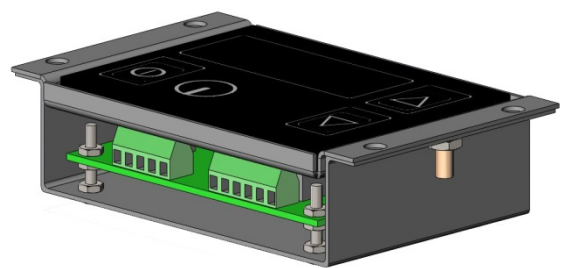
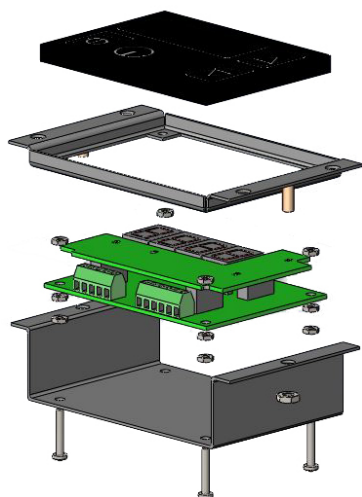

Technical documentation

Built-in drawings, spare part lists, operation and instruction manuals and CE declarations can be found and downloaded here:

www.induktion.de  www.induktion.de/download.html

Exploded view BKEA

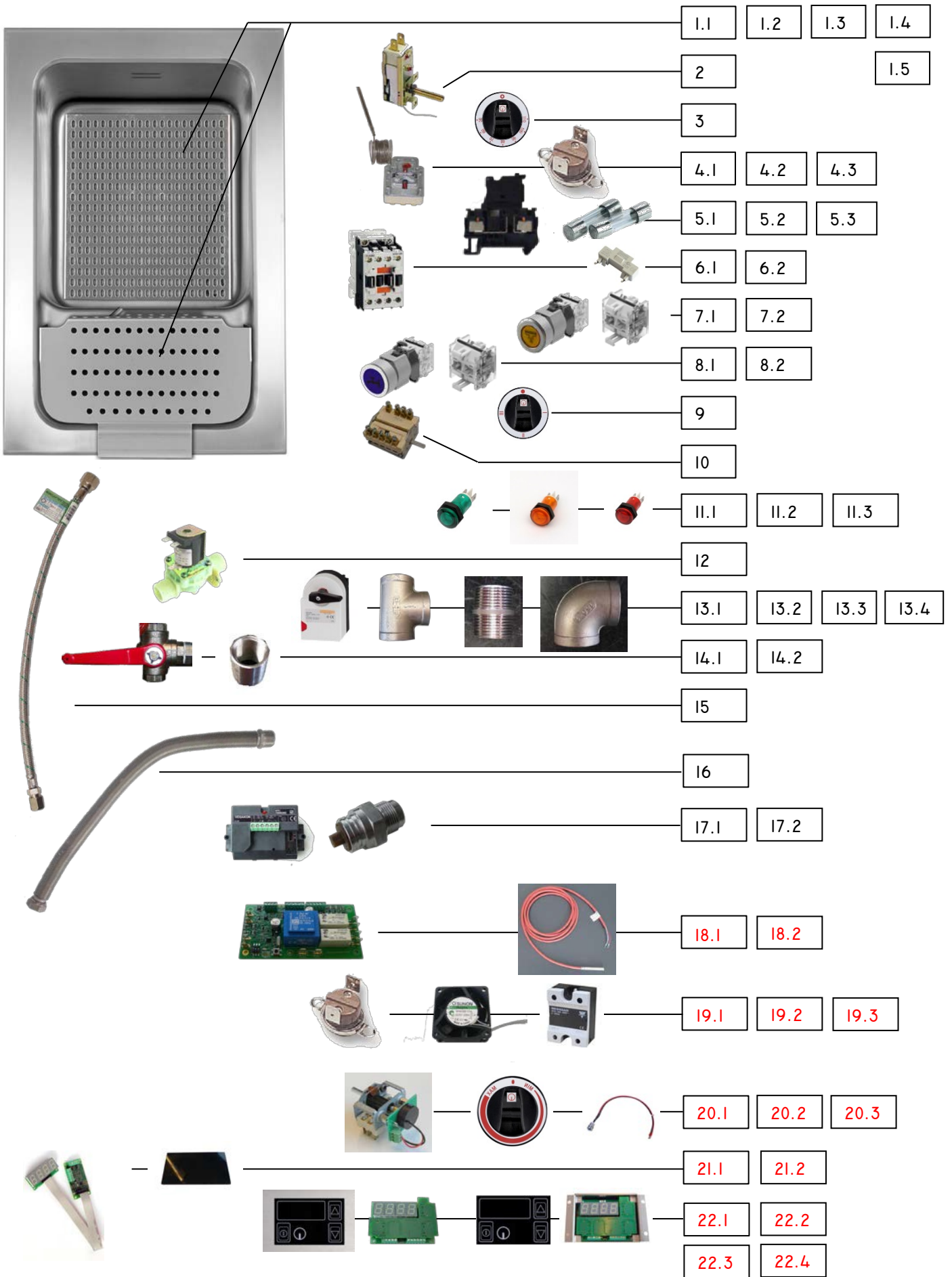

Exploded view BKEA

ANZAHL / PIECES			Pos.	ARTIKELNUMMER ITEM NUMBER	BESCHREIBUNG	DESCRIPTION
BKEA2/3 BKEA2/3E	BKEAI/I BKEAI/IE	BKEAQI/I BKEAQI/IE BKEAKI/I BKEAKI/IE				
1 / 1	-	-	1.1	002.10045	LOCHBLECH 2/3	PERFORATING METAL
-	1 / 1	1/1/1/1	1.2	002.10042	LOCHBLECH 1/1	PERFORATING METAL
1 / 1	-	-	1.3	002.10043	ABTROPFBLECH BKEA2/3	DRIP PLATE BKEA2/3
-	1 / 1	-	1.4	002.10041	ABTROPFBLECH BKEAI/I	DRIP PLATE BKEAI/I
-	-	1/1/1/1	1.5	002.10044	ABTROPFBLECH BKEAQI/I	DRIP PLATE BKEAQI/I
1 / -	1 / -	1/-/1/-	2	300116	THERMOSTAT 35-130°C	THERMOSTAT
1 / -	1 / -	1/-/1/-	3	501309-B	KNEBEL 0-110°C	KNOB 0-110°C
1 / -	1 / -	1/-/1/-	4.1	300169	SICHERHEITSTHERMOSTAT 237°C	SAFETY THERMOSTAT 237°C
- / 1	- / 1	-/1/-/1	4.2	300093	SICHERHEITSTHERMOSTAT 157°C	SAFETY THERMOSTAT 157°C
1 / -	1 / -	1/-/1/-	4.3	100145	BIMETALLSCHALTER NC	BIMETAL-SWITCH
1 / 1	1 / 1	1/1/1/1	5.1	301038	SICHERUNGSKLEMME PT4-HESI	FUSE SOCKET
1 / 1	1 / 1	1/1/1/1	5.2	501278	SICHERUNG F6,3A	FUSE F6,3A
1 / -	1 / -	1/-/1/-	5.3	501263	SICHERUNG T1A	FUSE T1A
1 / 1	1 / 1	1/1/1/1	6.1	800305	SCHÜTZ 25 AMPERE (BF9)	RELAIS 25 AMPERE (BF9)
- / 1	- / 1	-/1/-/1	6.2	800323	RC-GLIED	RC-ELEMENT
1 / 1 *WAS	1 / 1 *WAS	1/1/1/1 *WAS	7.1	300304	LEUCHTDRUCKTASTER WASSERABLAUF GELB NEU	PUSH BUTTOM WATER DRAW YELLOW
1 / 1 *WZN	1 / 1 *WZN	1/1/1/1 *WZN	7.2	704.900.5	SCHALTELEMENT ÖFFNER/SCHLIEßER	SWITCHINGELEMENT OPENER/CLOSER
1 / 1	1 / 1	1/1/1/1	8.1	300300	LEUCHTDRUCKTASTER WASSERZULAUF BLAU	PUSH BUTTOM WATER TAP BLUE
1 / 1	1 / 1	1/1/1/1	8.2	300305	SCHALTELEMENT ÖFFNER	SWITCHINGELEMENT OPENER
1 / 1	1 / 1	1/1/1/1	9	501311-B	KNEBEL HAUPTSCHALTER	KNOB MAIN SWITCH I-III
1 / -	1 / -	1 / -	10	800406	HAUPTSCHALTER 4-STUFEN	MAIN SWITCH 4 STEPS
1 / -	1 / -	1 / -	11.1	800201	LAMPE GRÜN 250 V	INDICATOR LIGHT GREEN
1 / -	1 / -	1 / -	11.2	800206	LAMPE ORANGE 250 V	INDICATOR LIGHT ORANGE
1 / -	1 / -	1 / -	11.3	800202	LAMPE ROT 250 V	INDICATOR LIGHT RED
1 / 1	1 / 1	1/1/1/1	12	300114	MAGNETVENTIL 230V ¾" / ½"	VALVE 230V ¾" / ½"
1 / 1 *WAS	1 / 1 *WAS	1/1/1/1 *WAS	13.1	300112	STELLANTRIEB FÜR WASSER ABLAUF 230VAC-50/60HZ	SERVO DRIVE FOR WATER SEQUENCE OF OPERATIONS
1 / 1	1 / 1	1/1/1/1	13.2	002.10034	1" T-STÜCK	1" T PIECE
2 / 2	2 / 2	2/2/2/2	13.3	400332	DOPPELNIPPEL EDELSTAHL 1"	1" CONNECTION PIPE
1 / 1	1 / 1	1/1/1/1	13.4	002.10077	ROHRBOGEN 90° 1G/1G 1"	PIPE BEND 90° 1"
1 / 1	1 / 1	1/1/1/1	14.1	300115	1" DREIWEGE-VENTIL	1" THREE WAY-VALVE
1 / 1	1 / 1	1/1/1/1	14.2	002.10090	1" MUFFE	1" PIPE
1 / 1	1 / 1	1/1/1/1	15	63415050	PANZERSCHLAUCH 500MM LANG NEOFLEX SPX 1/2 "	TANK HOSE 500MM LONG NEOFLEX SPX 1/2 "
1 / 1	1 / 1	1/1/1/1	16	300118	EDELSTAHLWELLSCHLAUCH 1"	HIGH-GRADE STEEL PIPE 1"
1 / 1 *WZN	1 / 1 *WZN	1/1/1/1 *WZN	17.1	300090	ELEKTRONIK WASSERSRAND	ELECTRONIC WATER LEVEL
1 / 1 *WZN	1 / 1 *WZN	1/1/1/1 *WZN	17.2	300091	SENSOR FÜR WASSERSTAND	SENSOR WATER LEVEL
- / 1	- / 1	-/1/-/1	18.1	300129	MULTICONTROLLER VER 4. XX	MULTICONTROLLER VER 4. XX
- / 1	- / 1	-/1/-/1	18.2	100377	KABELTEMPERATURFÜHLER SILIKON PT1000 2M 180°C	FEELER 180°C
- / 1	- / 1	-/1/-/1	19.1	100044	BIMETALLSCHALTER NO	BIMETAL-SWITCH
- / 1	- / 1	-/1/-/1	19.2	100300	LÜFTER 60x60x25MM 230V	COOLER 60x60x25MM 230V
- / 3	- / 3	-/3/-/3	19.3	800324	HALBLEITERRELAIS 40A	SOLID STATE RELAIS 40A
- / 1	- / 1	-/1/-/1	20.1	LPI-100108	POTI MIT VORSCHALTER	CONTROLLER WITH POTI
- / 1	- / 1	-/1/-/1	20.2	100122-B	KNEBEL MIN-MAX	KNOB MIN-MAX
- / 1	- / 1	-/1/-/1	20.3	100134	LED GRÜN HALTEBUCHSE	LED GREEN WITH SOCKET
- / 1	- / 1	-/1/-/1	21.1	100318	DIGITALE ANZEIGE I-9 VER. I	DIGITAL DISPLAY I-9 VER. I
- / 1	- / 1	-/1/-/1	21.2	100185	GLASS 39x69MM	CERANGLASS 39x69MM
- / *1	- / *1	-/*1/-/*1	22.1	100153	EINBAURAHMEN MIT TOUCHCONTROLGLAS	MOUNT IN FRAME WITH TOUCHCONTROL GLASS
- / *1	- / *1	-/*1/-/*1	22.2	300113	ELEKTRONIK TOUCHCONTROL	ELECTRONIC TOUCHCONTROL
- / *1	- / *1	-/*1/-/*1	22.3	100159	TOUCHCONTROLGLAS	TOUCHCONTROL GLASS
- / *1	- / *1	-/*1/-/*1	22.4	100177	EINBAURAHMEN VER. B	MOUNT IN FRAME VER. B

*Optionen WAS; WZN; ESRTN

Exploded view BKE

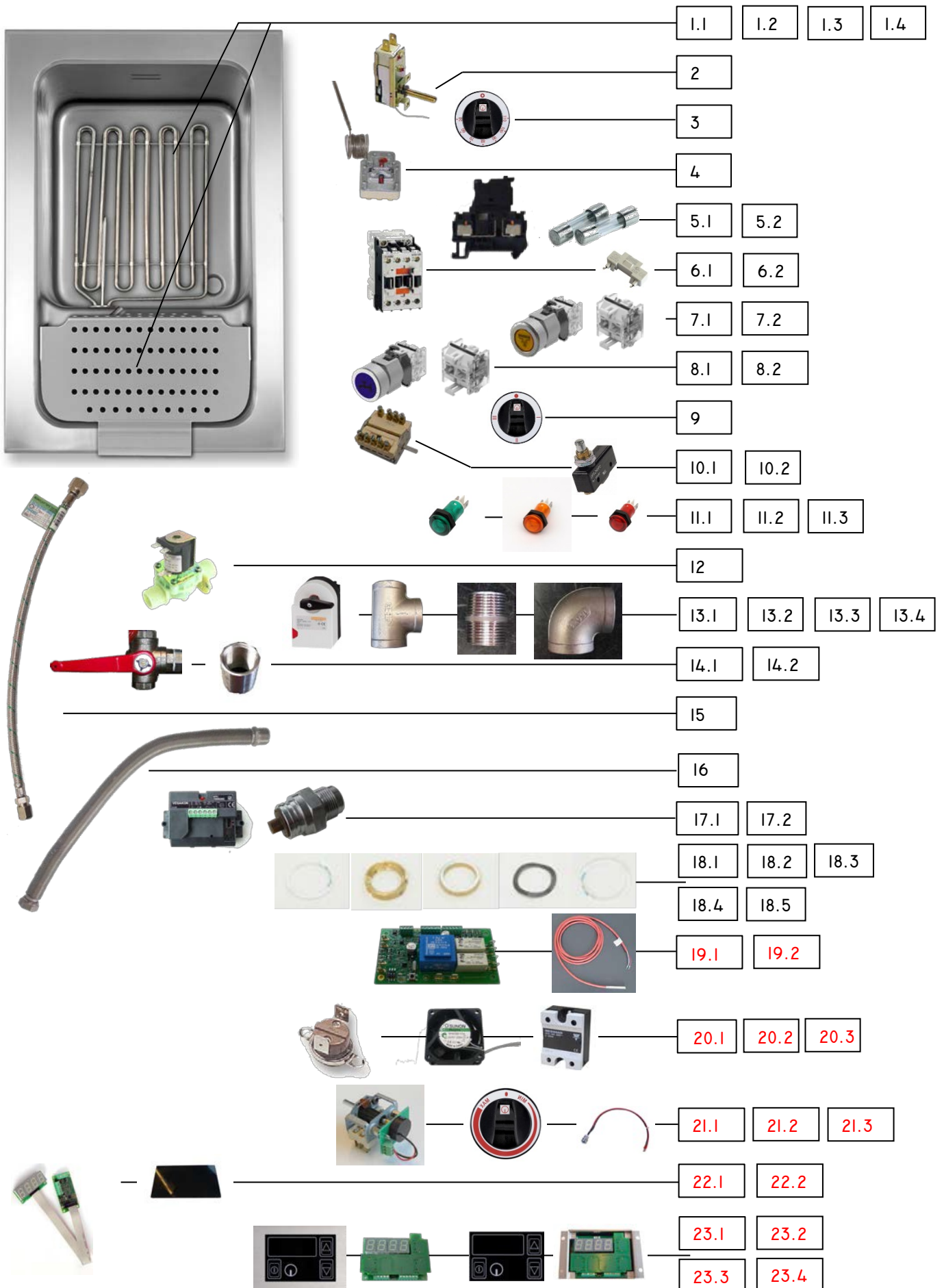

Exploded view BKE

ANZAHL / PIECES				Pos.	ARTIKELNUMMER ITEM NUMBER	BESCHREIBUNG	DESCRIPTION
BKE2/3 BKES2/3	BKEI/I BKESI/I	BKE2/3E BKES2/3E	BKEI/IE BKESI/IE				
1 / 1	-	1 / 1	-	1.1	002.10036	HEIZUNGSSCHUTZBLECH 2/3	PERFORATING METAL
-	1 / 1	-	1 / 1	1.2	002.10032	HEIZUNGSSCHUTZBLECH 1/1	PERFORATING METAL
1 / 1	-	1 / 1	-	1.3	002.10037	ABTROPFBLECH 2/3	DRIP PLATE 2/3
-	1 / 1	-	1 / 1	1.4	002.10124	ABTROPFBLECH 1/1	DRIP PLATE 1/1
1 / 1	1 / 1	- / -	- / -	2	300138	THERMOSTAT 30-130°C	THERMOSTAT
1 / 1	1 / 1	- / -	- / -	3	501309-B	KNEBEL 0-110°C	KNOB 0-110°C
1 / 1	1 / 1	1 / 1	1 / 1	4	300093	SICHERHEITSTHERMOSTAT 157°C	SAFETY THERMOSTAT 157°C
1 / 1	1 / 1	1 / 1	1 / 1	5.1	301038	SICHERUNGSKLEMME PT4-HESI	FUSE SOCKET
1 / 1	1 / 1	1 / 1	1 / 1	5.2	501264	SICHERUNG F6,3A	FUSE F6,3A
1 / 1	1 / 1	1 / 1	1 / 1	6.1	800305	SCHÜTZ 25 AMPERE (BF9)	RELAIS 25 AMPERE (BF9)
- / -	- / -	1 / 1	1 / 1	6.2	800323	RC-GLIED	RC-ELEMENT
1 / 1 *WAS	1 / 1 *WAS	1 / 1 *WAS	1 / 1 *WAS	7.1	300304	LEUCHTDRUCKTASTER WASSERABLAUF GELB	PUSH BUTTOM WATER DRAW YELLOW
1 / 1 *WAS	1 / 1 *WAS	1 / 1 *WAS	1 / 1 *WAS	7.2	EAO-704.900.5	SCHALTELEMENT ÖFFNER/SCHLIEßER	SWITCHINGELEMENT OPENER/CLOSER
1 / 1	1 / 1	1 / 1	1 / 1	8.1	300300	LEUCHTDRUCKTASTER WASSERZULAUF BLAU	PUSH BUTTOM WATER TAP BLUE
1 / 1	1 / 1	1 / 1	1 / 1	8.2	300305	SCHALTELEMENT ÖFFNER	SWITCHINGELEMENT OPENER
1 / 1	1 / 1	- / -	- / -	9	501311-B	KNEBEL HAUPTSCHALTER	KNOB MAIN SWITCH I-III
1 / 1	1 / 1	- / -	- / -	10.1	800406	HAUPTSCHALTER 4-STUFEN	MAIN SWITCH 4 STEPS
1 / 1	1 / 1	1 / 1	1 / 1	10.2	200353	MIKROSCHALTER STÖßEL 15A	MICROSWITCH
1 / 1	1 / 1	- / -	- / -	11.1	800201	LAMPE GRÜN 250V	INDICATOR LIGHT GREEN
1 / 1	1 / 1	- / -	- / -	11.2	800206	LAMPE GELB 250V	INDICATOR LIGHT YELLOW
1 / 1	1 / 1	1 / 1	1 / 1	11.3	800202	LAMPE ROT 250V	INDICATOR LIGHT RED
1 / 1	1 / 1	1 / 1	1 / 1	12	300114	MAGNETVENTIL 230V ¾" / ½"	VALVE 230V ¾" / ½"
1 / 1 *WAS	1 / 1 *WAS	1 / 1 *WAS	1 / 1 *WAS	13.1	300112	STELLANTRIEB FÜR WASSERABLAUF230VAC-50/60HZ	SERVO DRIVE FOR WATER SEQUENCE OF OPERATIONS
1 / 1	1 / 1	1 / 1	1 / 1	13.2	002.10034	1" T-STÜCK	1" T PIECE
1 / 1	1 / 1	1 / 1	1 / 1	13.3	400332	DOPPELNIPPEL EDELSTAHL 1"	1" CONNECTION PIPE
1 / 1	1 / 1	1 / 1	1 / 1	13.4	002.10077	ROHRBOGEN 90° IG/IG 1"	PIPE BEND 90° 1"
1 / 1	1 / 1	1 / 1	1 / 1	14.1	300115	1" DREIWEGE-VENTIL	1" THREE WAY-VALVE
1 / 1	1 / 1	1 / 1	1 / 1	14.2	002.10090	1" MUFFE	1" PIPE
1 / 1	1 / 1	1 / 1	1 / 1	15	63415050	PANZERSCHLAUCH 500MM LANG NEOFLEX SPX 1/2 "	TANK HOSE 500MM LONG NEOFLEX SPX 1/2 "
1 / 1	1 / 1	1 / 1	1 / 1	16	300118	EDELSTAHLWELLSCHLAUCH 1"	HIGH-GRADE STEEL PIPE 1"
- / -	- / -	1 / 1	1 / 1	17.1	100300	LÜFTER 60X60X25MM 230V	COOLER 60X60X25MM 230V
- / -	- / -	1 / 1	1 / 1	17.2	100044	BIMETALLSCHALTER NO	BIMETAL SWITCH
1 / 1 *WZN	1 / 1 *WZN	1 / 1 *WZN	1 / 1 *WZN	18.1	300090	ELEKTRONIK WASSERSTAND	ELECTRONIC WATER LEVEL
1 / 1 *WZN	1 / 1 *WZN	1 / 1 *WZN	1 / 1 *WZN	18.2	300091	SENSOR FÜR WASSERSTAND	SENSOR WATER LEVEL
- / -	- / -	1 / 1	1 / 1	19.1	300129	MULTICONTROLLER VER 4.xx	MULTICONTROLLER VER 4.xx
- / -	- / -	1 / 1	1 / 1	19.2	100372	FÜHLER PT1000	FEELER PT1000
- / -	- / -	3 / 3	3 / 3	19.3	800324	HALBLEITERRELAIS 40A 480V	SOLID STATE RELAIS
1 / 1	1 / 1	1 / 1	1 / 1	20.1	300428	TEFLONRING MIT INNENNUT	TEFLON RING INSIDE SLOT
1 / 1	1 / 1	1 / 1	1 / 1	20.2	300427	MESSINGRING MIT 1/A NUT	BRASS RING I/O SLOT
1 / 1	1 / 1	1 / 1	1 / 1	20.3	300426	MESSINGRING MIT INNENNUT	BRASS RING INSIDE SLOT
1 / 1	1 / 1	1 / 1	1 / 1	20.4	300430	SPANNRING 79MM	TENSION RING 79MM
1 / 1	1 / 1	1 / 1	1 / 1	20.5	300429	TEFLONRING MIT AUSSENNUT	TEFLON RING OUTSIDE SLOT
- / -	- / -	1 / 1	1 / 1	21.1	LPI-100108	POTI MIT VORSCHALTER	CONTROLLER WITH POTI
- / -	- / -	1 / 1	1 / 1	21.2	100122	KNEBEL	KNOB
- / -	- / -	1 / 1	1 / 1	21.3	100134	LED GRÜN HALTEBUCHSE	LED GREEN WITH SOCKET
- / -	- / -	1 / 1	1 / 1	22.1	100318	DIGITALE ANZEIGE 1-9 VER. I	DIGITAL DISPLAY 1-9 VER. I
- / -	- / -	1 / 1	1 / 1	22.2	100185	GLASS 39X69MM	CERANGLASS 39X69MM
- / -	- / -	1 / 1 *ESRTN	1 / 1 *ESRTN	23.1	100153	EINBAURAHMEN MIT GLAS FÜR SENSOR TASTENFELD	MOUNT IN FRAME WITH TOUCHCONTROL GLASS
- / -	- / -	1 / 1 *ESRTN	1 / 1 *ESRTN	23.2	300113	ELEKTRONIK TOUCHCONTROL	ELECTRONIC TOUCHCONTROL
- / -	- / -	1 / 1 *ESRTN	1 / 1 *ESRTN	23.3	100159	TOUCHCONTROLGLAS	TOUCHCONTROL GLASS
- / -	- / -	1 / 1 *ESRTN	1 / 1 *ESRTN	23.4	100177	EINBAURAHMEN VER. B	MOUNT IN FRAME VER. B

*Optionen WAS; WZN; ESRTN

Exploded view BKE

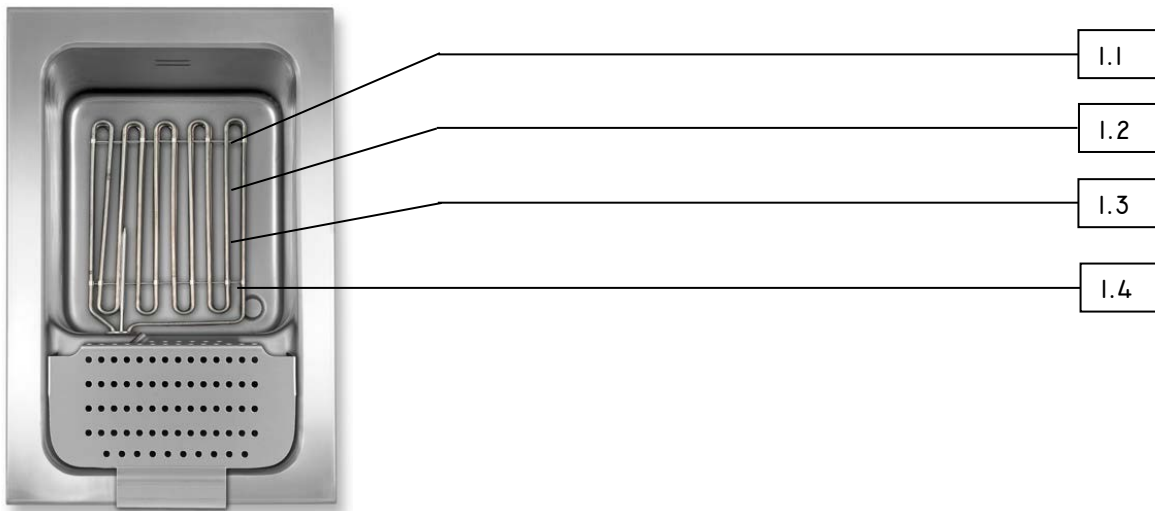

ANZAHL / PIECES				Pos.	ARTIKELNUMMER ITEM NUMBER	BESCHREIBUNG	DESCRIPTION
BKE2/3 BKE2/3E	BKE1/1 BKE1/1E	BKES2/3 BKES2/3E	BKES1/1 BKES1/1E				
1 / 1	-	-	-	1.1	300403	HEIZUNG 2/3 8,0kW	HEATING ELEMENT 8,0kW
-	1 / 1	-	-	1.2	300404	HEIZUNG 1/1 10,0kW	HEATING ELEMENT 10,0kW
-	-	1 / 1	-	1.3	300400	HEIZUNG 2/3 12,0kW	HEATING ELEMENT 12,0kW
-	-	-	1 / 1	1.4	300401	HEIZUNG 1/1 15,0kW	HEATING ELEMENT 15,0kW

Exploded view BKEA_H

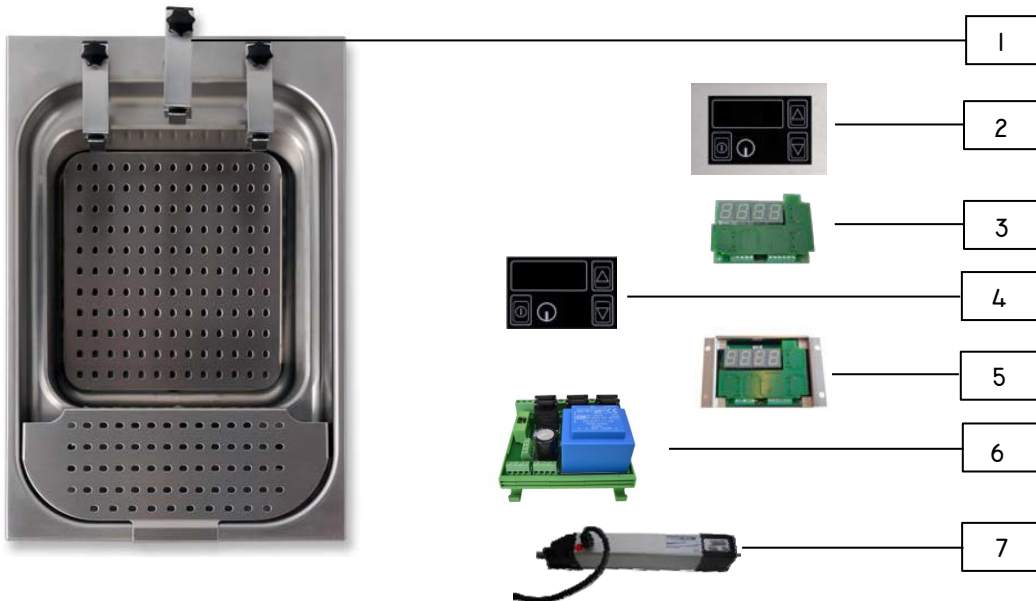

ANZAHL / PIECES		Pos.	ARTIKELNUMMER ITEM NUMBER	BESCHREIBUNG	DESCRIPTION
BKEA2/3H BKEA2/3HE					
1 / 1		1	BNKHI+	KORBHEBEAUTOMATIK FÜR NUDELKOCHER	BASKET AUTOMATIC LIFTING FOR PASTA COOKER
3 / 3		2	100153	EINBAURAHMEN MIT GLAS FÜR SENSOR TASTENFELD	MOUNT IN FRAME WITH TOUCHCONTROL GLASS
3 / 3		3	300113	ELEKTRONIK TOUCHCONTROL	ELECTRONIC TOUCHCONTROL
3 / 3		4	100159	TOUCHCONTROLGLAS	TOUCHCONTROL GLASS
3 / 3		5	100177	EINBAURAHMEN VER. B	MOUNT IN FRAME VER. B
3 / 3		6	100159	TIMERRELAIS	TIMER RELAIS
3 / 3		7	100177	HUBMOTOR FÜR HEBEAUTOMATIK	LIFTMOTOR FOR LIFTAUTOMATIC

